



TEXAS DEPARTMENT OF TRANSPORTATION



## GALVESTON COUNTY TRANSPORTATION SUMMIT

TxDOT Project Overview-Galveston County



September 1, 2016

### Table of Contents

1

Transportation Funding

2

Galveston County Projects

3

Projects Under Construction – Jamal Elahi-Galveston Area Engineer

# TRANSPORTATION FUNDING

Bill Brudnick, P.E.  
 Director of Transportation Planning and Development  
 Texas Department of Transportation  
 Houston District

## A Snapshot of the Problem

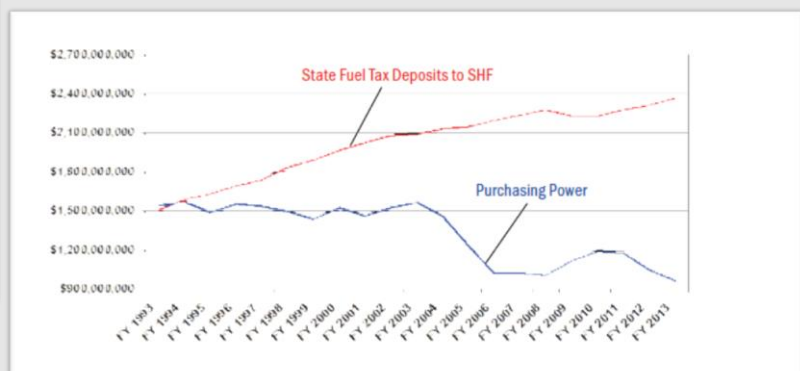
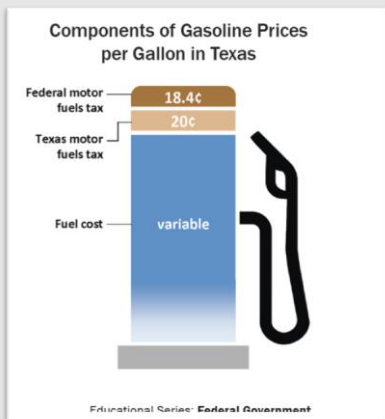

## Proposition 1 Funding – 83<sup>rd</sup> Texas Legislature

- Proposition 1 was passed in 2014
- Funds were allocated from the State Rainy-Day Fund
  - Tied to Crude Oil prices
- Used to accelerate and construct projects in Galveston County:
  - FM 646 Widening (FM 1764 to SH 6)
    - \$12.8 Million
  - I-45 Widening (FM 518 to FM 517 – 10/2016)
    - \$130 Million
  - Numerous Asphalt Overlay Projects



*State Rainy Day Fund*



## 84<sup>th</sup> Texas Legislature

- Transportation funding was a key priority
- FY 2016-2017 TxDOT Statewide Appropriation:
  - \$23 Billion Total (State Plus Federal Funds)
    - Ending diversions increase (\$1.3 Billion)
    - Proposition 1 Funding (\$2.4 Billion)
- TxDOT Budget
  - Planning and Design (\$1.7 Billion)
  - Right-of-Way Acquisition (\$0.9 Billion)
  - Maintenance (\$8.9 Billion)
  - Construction (\$5.1 Billion)
  - Prop 1 Allocations (\$2.4 Billion)
  - Debt Service (\$2.2 Billion)



## Proposition 7

### Constitutional amendment to allocate a portion of general sales tax and motor vehicle sales tax revenues to the State Highway Fund.

- Estimated revenue gain for the State Highway Fund:

FY 2018	\$2.5 billion
FY 2019	\$2.5 billion
FY 2020	\$2.9 billion
FY 2021	\$3.0 billion

- Proposition 7 passed November 3, 2015
- Over 83% support

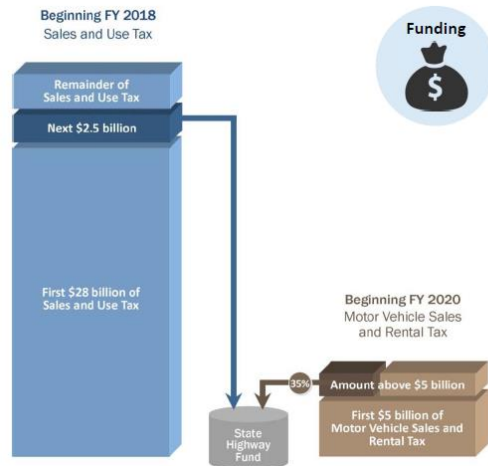

## TxDOT Houston District Construction Funding

- TxDOT Houston District Funding Caps
  - FY 2016 estimated letting (\$1.59 Billion)
    - Includes funding from Prop 1 (\$192 Million)
    - Includes the SH 288 Toll Project
  - FY 2017 estimated letting (\$1.95 Billion)



# GALVESTON COUNTY PROJECTS



## Hurricane Evacuation Routes



I-45 Primary Evacuation Route to Dallas-Fort Worth  
*Plan: Widen to 8 Main Lanes from NASA 1 to 61<sup>st</sup> St.*



SH 87: Primary Evacuation Route for Bolivar Peninsula  
*Plan: Protect and Rehabilitate Roadway from Storm Surge*



SH 146: Evacuation Route to US 59 Contraflow  
*Plan: Remove bottleneck at SH 3 and Widen to Kemah*



SH 6: Evacuation Route to US 290 and I-10 Contraflow



## I-45 Gulf Freeway: NASA 1 to FM 1764

### Reconstruct and Widen from 6 to 8 Main Lanes

- FM 518 to FM 517 – Anticipated Letting Oct. 2016  
– Construction Cost Estimate: \$130 M
- NASA 1 to FM 518 – Anticipated Letting Apr. 2017  
– Construction Cost Estimate: \$100 M
- FM 517 to FM 1764 – Anticipated Letting FY 2018  
– Construction Cost Estimate: \$150 M



## I-45 Gulf Freeway: FM 1764 to 61<sup>st</sup> Street

### Reconstruct and Widen from 6 to 8 Main Lanes

- FM 1764 to FM 519 – Anticipated Letting 2019  
– Construction Cost Estimate: \$122 Million
- FM 519 to Causeway – Anticipated Letting 2020  
– Construction Cost Estimate: \$320 Million
- Causeway to 61<sup>st</sup> – Anticipated Letting 2021  
– Construction Cost Estimate: \$104 Million

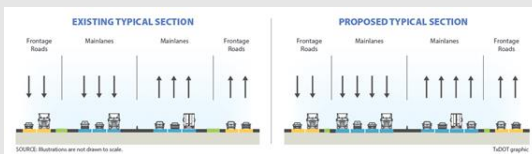

## SH 87 Bolivar Peninsula

### Rollover Pass to High Island

- \$11 Million to repair SH 87
- Anticipated Letting: Nov. 2017

Based on Hydraulic Study along four reaches

Solutions include:

- Raise low lying sections of roadway
- Rock revetment protection
- Reduce beach access where possible
- Realignment roadway at SH 124



## SH 146 Corridor



### Red Bluff to FM 518

- Union Pacific Railroad easement
  - Negotiations on-going
- Right-of-way acquisitions on-going
- Seabrook-Freeway/Kemah-Express
- Widen existing Kemah Bridge
- Construct new express bridge
- Estimated Construction Cost: \$190M
- Anticipated Letting - May 2018

### FM 518 to FM 517

- Widen to 6 lane boulevard
- Overpass at SH 96
- Anticipated letting - 2022
- Estimated Construction Cost: \$85 Million

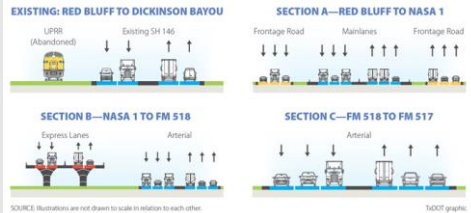

## SH 146 AT SH 3/TCT Railroad

### SH 146 at TCT RR Bridge

- Only 2-Lane segment of the SH 146 Corridor
- Major Bottleneck for Hurricane Evacuation
- Proposed Project
  - Reconstruct and Realign Railroad Crossing
  - Elevated T Intersection with SH 3
- Anticipated Letting - FY 2020
- Estimated Construction Cost: \$30 Million
- Bridge Replacement Funds



Existing

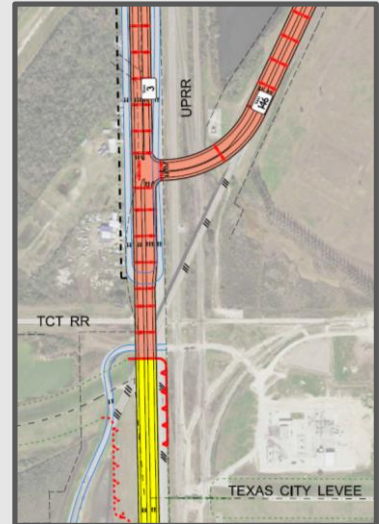

Proposed

## Other Galveston Area Projects

- FM 517 (I-45 to SH 35)
  - Widen to four-lane divided
  - Schematic/Environmental On-going
- FM 646 (SH 3 to SH 146)
  - Widen to four-lane divided
  - Anticipated Letting - 2022-2023 (\$70 Million)





# PROJECTS CURRENTLY UNDER CONSTRUCTION

## Galveston Area and Maintenance Offices

### Office Responsibilities

- The Galveston Area and Maintenance Offices are responsible for construction and maintenance to all roadways and bridges within Galveston County. Our office is also responsible for emergency response within Galveston County during natural and manmade disasters.
- Our project managers and inspectors oversee, inspect and lend support to contractors before and during the construction process up to final inspection and acceptance of the projects. The Galveston Area Office has 22 employees and the Maintenance Office has 26 employees. All 48 employees are committed to safety in and around Galveston County.

### Coordination with Local Governments:

- We enjoy a good working relationship with Galveston County Commissioners and local city government.
- We work closely with city and county government to keep local business and the public informed of all maintenance and construction projects. For example, I meet quarterly with League City Chamber of Commerce and League City's City Manager and City Engineer to discuss upcoming projects and status of current projects. I have also been invited to serve on the Texas City Steering Committee which is focused on the enhancement of mobility infrastructure within their city.
- Two websites are in place and accessible by the public with road closure information and construction status information specifically for upcoming IH 45 projects within Galveston County: <http://www.txdot.gov/inside-txdot/projects/studies/houston/ih45-nasa1.html>  
<http://txdot.gov/inside-txdot/projects/studies/houston/ih45-fm518.html>
- DriveTexas.org is in place for all road conditions and closures for the traveling public.

## I-45 Gulf Freeway (Harris County)

### BW 8 to FM 2351

- **Widen from 6 to 10 mainlanes**
- Widen from two to three frontage road lanes
- **Extend reversible HOV**
- Replace two overpasses
- **\$77.5M**
- 88% complete
- Estimated completion **Summer 2017**

### FM 2351 to Medical Center Blvd.

- **Widen from 6 to 10 mainlanes**
- Widen from two to three frontage road lanes
- **Extend reversible HOV**
- Replace two overpasses
- **\$93M**
- 82% complete
- Estimated completion **Winter 2017**

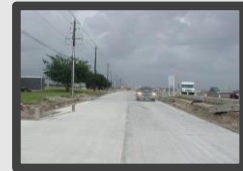

## Galveston County Current Construction Projects

- |   |   |
|---|---|
| <ul style="list-style-type: none"> <li>▪ I-45: Calder Drive to FM 646 (\$2.056 M)                     <ul style="list-style-type: none"> <li>▪ Southbound Ramp Reversals</li> <li>▪ 100% Complete November 2015</li> </ul> </li> <li>▪ Seawall Blvd: 39<sup>th</sup> Street to Ferry road (2.021 M)                     <ul style="list-style-type: none"> <li>▪ Pavement Milling and Overlay</li> <li>▪ 98% Complete / Estimated Completion Fall 2016</li> </ul> </li> <li>▪ FM 518 Bay Area Blvd to FM 2094 (\$1.295 M)                     <ul style="list-style-type: none"> <li>▪ Access Management Improvements</li> <li>▪ 100% Complete December 2015</li> </ul> </li> <li>▪ FM 646: FM1764 to SH 6 (\$12.83 M)                     <ul style="list-style-type: none"> <li>▪ Roadway Widening from 2 Lanes to 4 Lane Divided</li> <li>▪ 7% Complete / Estimated Completion Winter 2017</li> </ul> </li> <li>▪ SH 6: I-45 to FM 2004 (\$3.4 M)                     <ul style="list-style-type: none"> <li>▪ Pavement Milling and Overlay</li> <li>▪ 60% Complete</li> </ul> </li> <li>▪ FM 517: Brazoria C/L to FM 646 (\$ 3.08 M)                     <ul style="list-style-type: none"> <li>▪ Pavement Milling and Overlay</li> <li>▪ 98% Complete</li> </ul> </li> </ul> | <ul style="list-style-type: none"> <li>▪ 61<sup>st</sup> Street: I-45 to Seawall Blvd (\$1.76 M)                     <ul style="list-style-type: none"> <li>▪ Pavement Milling and Overlay</li> <li>▪ Start Date 9/5/2016</li> </ul> </li> <li>▪ I-45: FM 1764 to Texas City Wye (\$9.5 M)                     <ul style="list-style-type: none"> <li>▪ Pavement Overlay</li> <li>▪ 98% Complete</li> </ul> </li> <li>▪ I-45: FM 518 to FM 517 (\$4.7 M)                     <ul style="list-style-type: none"> <li>▪ Pavement Overlay</li> <li>▪ 98% Complete</li> </ul> </li> <li>▪ FM 519: SH 3 to LP 197 (\$1.6 M)                     <ul style="list-style-type: none"> <li>▪ Pavement Milling and Overlay</li> <li>▪ Start Date 8/30/2016</li> </ul> </li> </ul> |
|---|---|

### Galveston Area Construction Projects

Total Contracted Amount - \$99.75 M

Total Remaining Balance - \$94.5 M

Number of Projects - 27

